

Standard Rectangular Cordlock

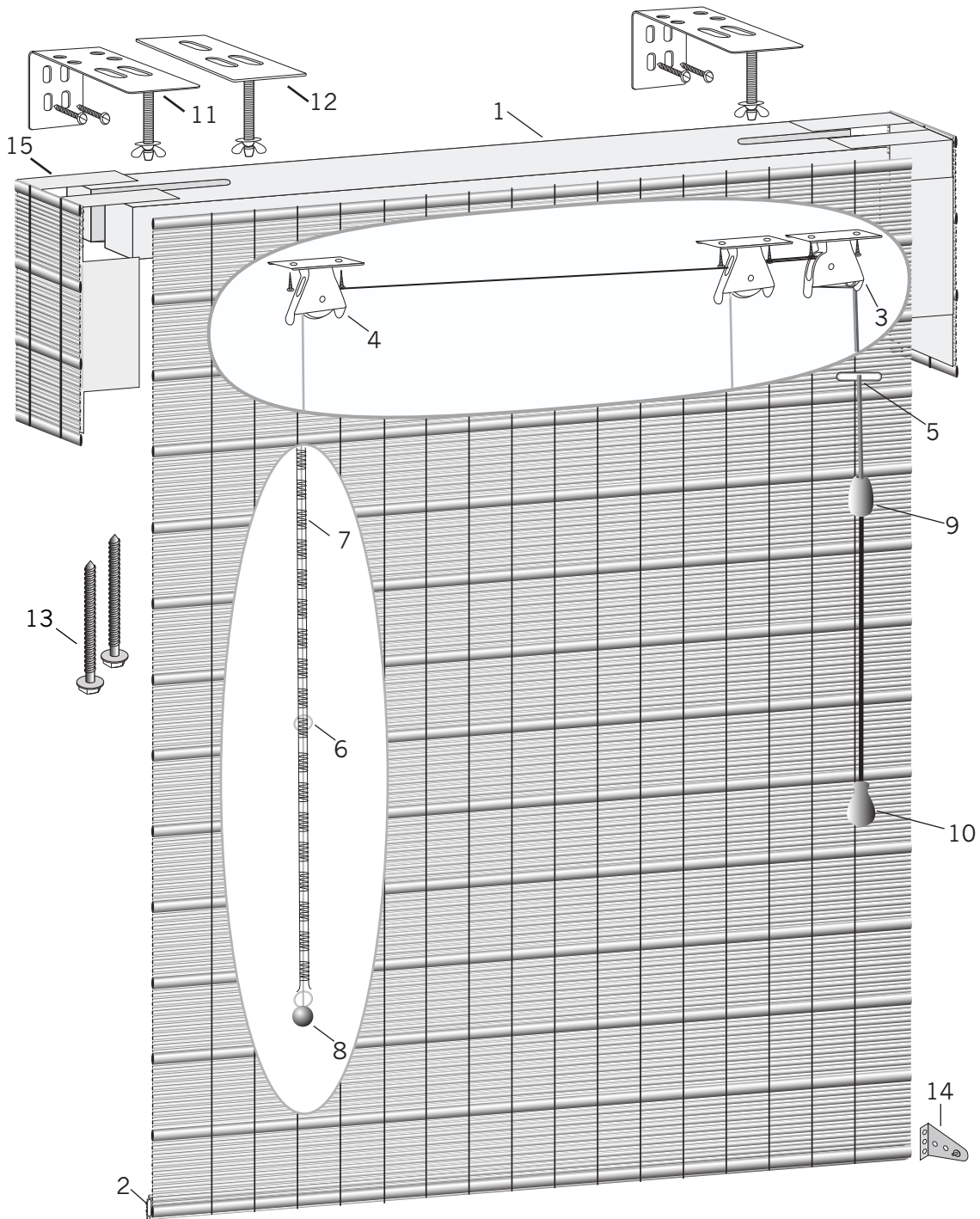

Standard Parts

- | | | |
|-----------------------|------------------------------------|--|
| 1. Headrail | 7. Cord | 12. Ceiling Mount Brackets (Optional) |
| 2. Bottom Wood Slat | 8. Round Cord Stop | 13. Turned Headrail Installation Screws (Optional) |
| 3. Swivel Cordlock | 9. Stop Ball | 14. Hold-Down Brackets (Optional) |
| 4. Swivel Cord Pulley | 10. Tassel | 15. Returns |
| 5. Oblong Grommet Set | 11. Standard Installation Brackets | |
| 6. Split Ring | | |

Standard Rectangular Cordlock

No.	PCN	Description	Additional Components (Not Shown):	
1.	Woven Wood Headrail		WWC906xxx	Headrail Tape
	RWC60007x	1" × 1¾" × 16' Standard	RWC60005x	Staples
	RWC60007x	1¾" × 1" × 16' Turned	RWC600009	¾" Screw for Hardware (Antique Finish)
2.	WWC900250	Bottom Wood Slat	7107684000	Cord Stop Safety Hang Tag
3.	RWC600002	Swivel Cordlock	LIT888268	ANSI 5.2.8 Back Cord Warning Tag
4.	WWC900023	Swivel Cord Pulley	LIT888112	Provenance® Woven Wood Hang Tag
5.	Oblong Grommet Set		WWC900200	Cord Cleat with Screws (Antique Finish)
	WWC904011	Bras)	WWC900232	Extension Brackets (3 Pack)
	WWC90426x	Other Colors	WWCTEBxxx	Twill Edge Banding
6.	WWC900210	Split Ring	WWCNEBxxx	Narrow Grosgrain Edge Banding
7.	WWC925xxx	1.8 mm Cord Shroud	WWCWEBxxx	Wide Grosgrain Edge Banding
8.	555096	Round Cord Stop (Clear)	WWCCEBxxx	Chevron Edge Banding
9.	RWC60027x	Wood Stop Ball	WWC90019x	Edge Banding Thread
10.	RWC90010x	Wood Cord Tassel (with logo)	WWC900240	Glue (Hot Melt Adhesive)
11.	Woven Wood Standard Installation Brackets		WWC900166	1½" Double Faced Tape for Returns
	WWC900202	2 Pack	LIT888604	3" × 2" Label for Returns Packaging
	WWC900203	3 Pack		
12.	Woven Wood Ceiling Mount Brackets			
	WWC900214	2 Pack		
	WWC900215	3 Pack		
13.	Turned Headrail Installation Screws			
	KIT6100	8 pack - 2 ½" Wall Mount (4), 3" Ceiling Mount (4)		
	KIT6101	12 pack - 2 ½" Wall Mount (6), 3" Ceiling Mount (6)		
14.	WWC900205	Hold-Down Brackets (with Screws)		
15.	Returns			
	WWC900014	Right Side Return		
	WWC900015	Left Side Return		

Sales Aids/Collateral Materials:

WWCSBK008	Provenance Woven Wood Shades Sample Book
LIT888608	Provenance Woven Wood Shades 2010 Update Kit
LIT888230C	Provenance Woven Wood Shades Installation Instructions (English)
LIT888230CF	Provenance Woven Wood Shades Installation Instructions (French)
LIT888607	Comprehensive Provenance Sell Sheet
LIT888609	2010 Provenance Sell Sheet
WW888601	Roman Style Cordlock Hand Sample with Narrow Edge Banding (18" × 24") – Sierra, White Bark Pine
WW888605	Classic Style Cordlock Hand Sample with LF Liner (18" × 24") – Serengeti, Maasai Shield
WW888606	Hobbled Style Cordlock Hand Sample (18" × 32") – Rolling Meadows, Barley Fields

Note: x, xx, or xxx = color code